

Shoelace Technique Guide

Six Anchor Technique

Step 1

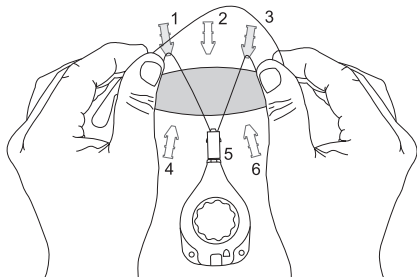

Seat tension controller under tab of home anchor (#5), loop line under anchor tab #1 and 3.

Step 2

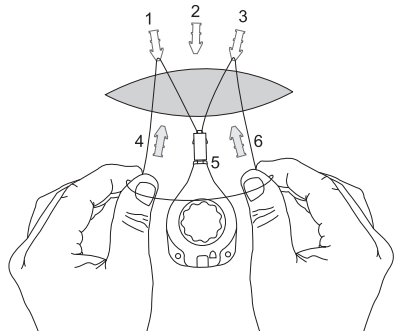

Loop line under anchor tab #4 and 6.

Step 3

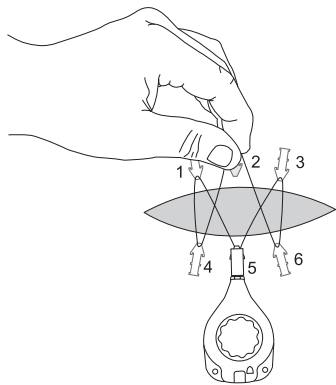

Loop remaining line under tab on anchor #2, turn blue control knob clockwise until audible clicking is heard (approx. 12 full rotations).

Eight Anchor Technique

Step 1

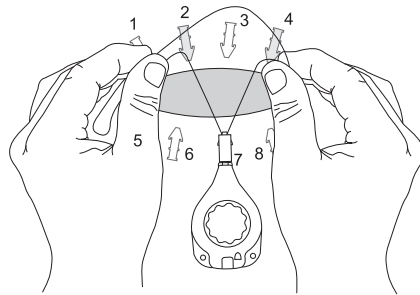

Seat tension controller under tab of anchor #7 (#6 could also be used), loop line under anchor tab #2 and 4.

Step 2

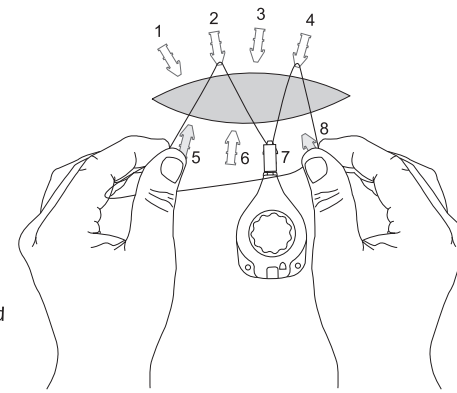

Loop line under anchor tab under #5 and 8.

Step 3

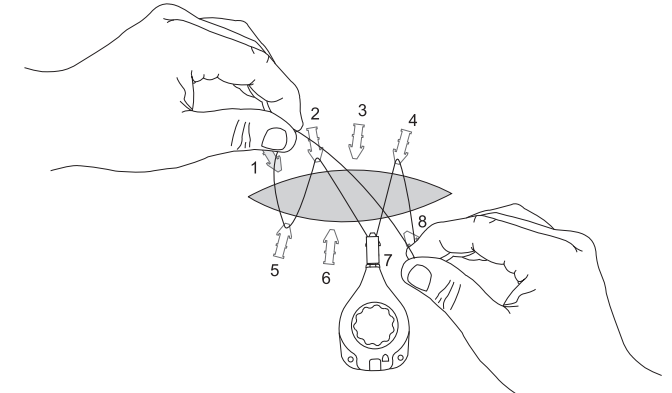

With left hand loop line under anchor tab #1 while pausing at anchor #8 with right hand.

Step 4

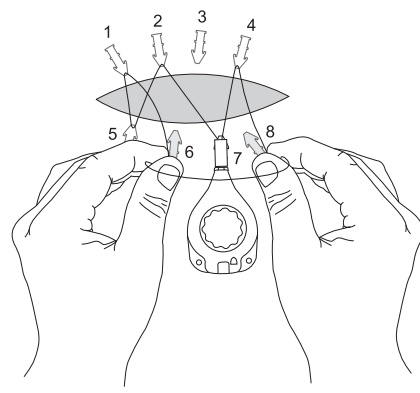

With left hand loop line under anchor tab #6 while #8 (right hand) remains paused.

Step 5

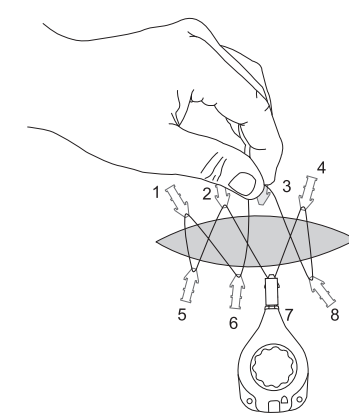

Loop remaining line under tab on anchor #3, turn blue control knob clockwise until audible clicking is heard (approx. 12 full rotations).

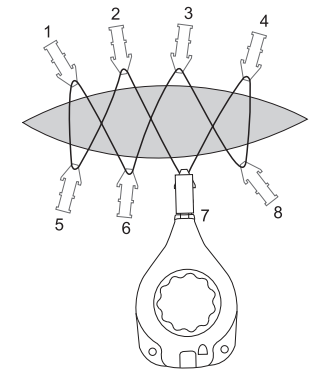

NOTE: For wounds longer than 10 cm and/or wider than 5 cm multiple devices may be used in series.

DR-0084_C

Shoelace Technique Guide

Ten Anchor Technique

Step 1

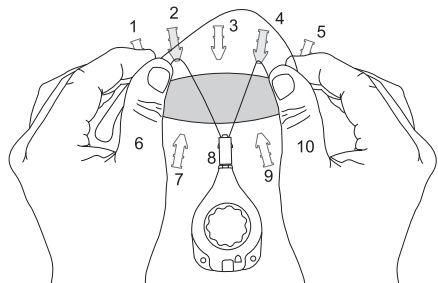

Seat tension controller under tab of home anchor (#8), loop line under anchor tab #2 and 4.

Step 2

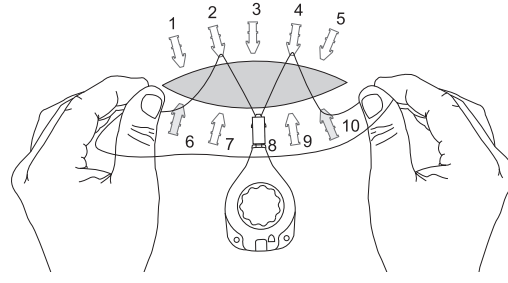

Loop line under anchor tab #6 and 10.

Step 3

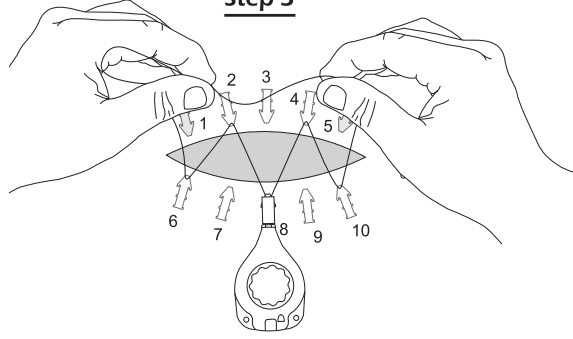

Loop line under anchor tab #1 and 5.

Step 4

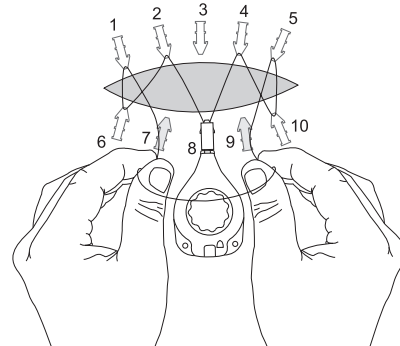

Loop line under anchor tab #7 and 9.

Step 5

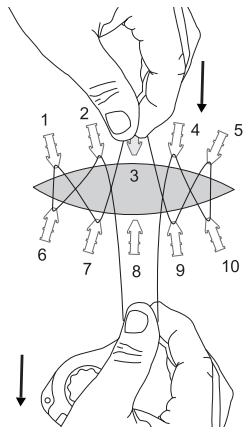

To take up slack pull tension controller while allowing line to loop under anchor #3.

Step 6

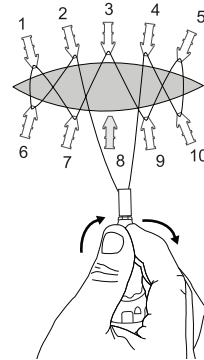

To take up remaining slack turn tension controller clockwise and seat into home anchor #8.

To Pull Out Tension Line

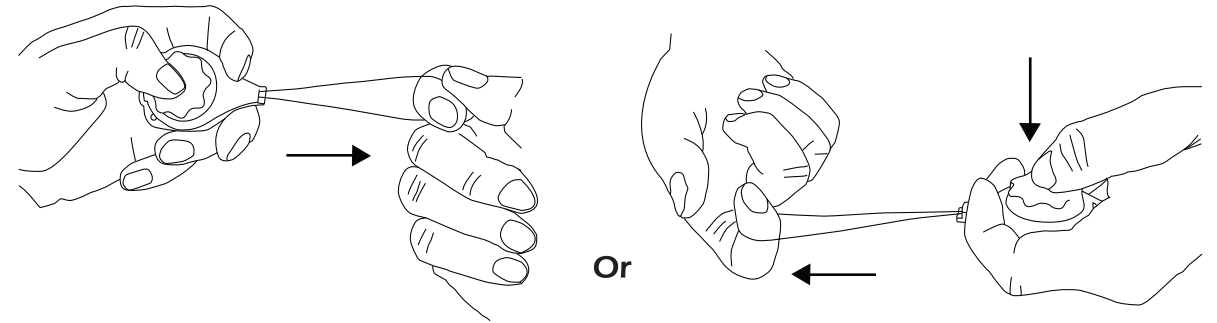

Press down on the center of the tension controller knob while pulling the line out with the other hand. It may be helpful to press the blue knob in and out.

Prevent Loop or Eyelit

CAUTION:
Be sure that a loop or eyelit is NOT created in the tension line

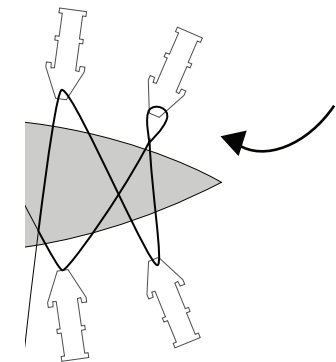

NOTE: For wounds longer than 10 cm and/or wider than 5 cm multiple devices may be used in series.